

# floorplan

## 1st Floor

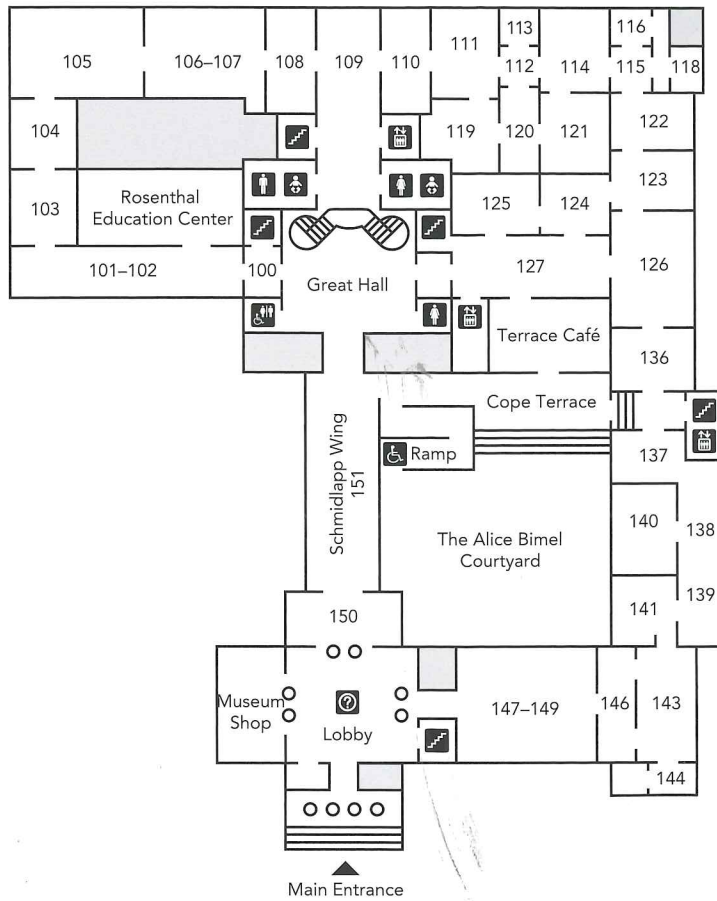

## 2nd Floor

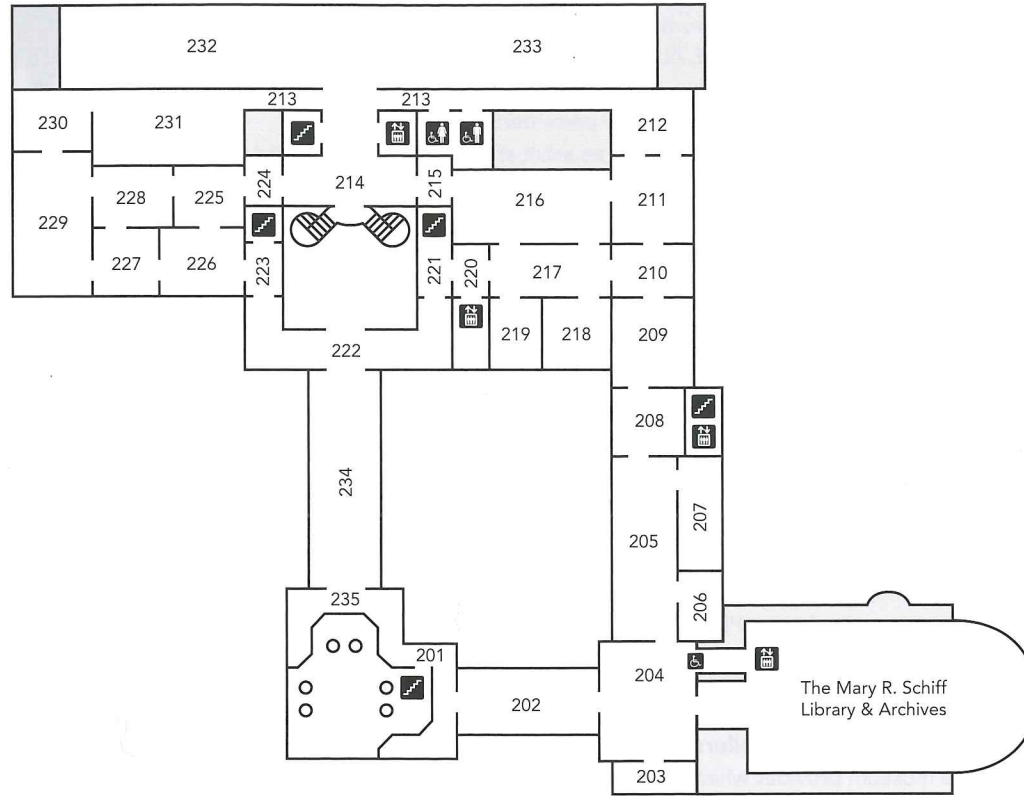

## Ground Floor

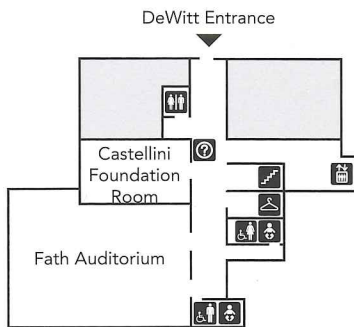

## 3rd Floor

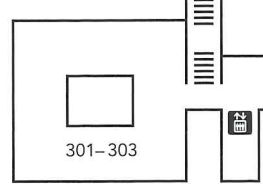

## Legend

- Information Desk
- Stairs
- Elevators
- Restrooms
- Wheelchair Access
- Baby Changing Stations

# what to visit

### Terrace Café

Enjoy a delicious selection of art-inspired fare, friendly servers and a tranquil atmosphere in our Terrace Café. Outdoor seating may be available in the scenic Alice Bimel Courtyard in warm weather. Museum members receive a discount. The Terrace Café is open Tuesday–Sunday, 11 a.m.–3 p.m. A limited menu is served on Thursday evenings from 3–7:30 p.m. Café reservations can be made by calling 513-639-2986.

### Museum Shop

Find unique gifts and keepsake souvenirs based on our special exhibitions and the museum's permanent collection. The shop is open during regular museum hours. Complimentary gift wrap available. Members receive a discount.

### The Mary R. Schiff Library

With a collection of over 100,000 items spanning 6,000 years of art history, the library is open to the public with highly-qualified librarians to assist visitors. Located on the third floor in the Longworth Wing, the library is Tuesday–Friday from 11 a.m.–5 p.m. as well as the second Saturday of each month.

### The Rosenthal Education Center

The Rosenthal Education Center (REC) is an interactive space for families to explore art together. Located on the first floor just off the Great Hall, the REC is open Tuesday–Sunday 11 a.m.–5 p.m. Thursday hours are 11 a.m.–8 p.m.

### Coffee Bar

Have a seat and enjoy cookies and a cup of gourmet coffee or tea. Open during regular museum hours, but closes 30 minutes before museum closing time.

# special exhibitions

### *Fashion and Technology*

July 1, 2017—December 3, 2017 | Gallery 104

### *Anila Agha: All the Flowers are for Me*

June 17, 2017—October 15, 2017 | Gallery 234–235

### *A Shared Legacy: Folk Art in America\**

June 10, 2017—September 3, 2017 | Gallery 232–233

### *William Kentridge: More Sweetly Play the Dance*

April 26, 2017—January 28, 2018 | Gallery 105

### *Tiffany Glass: Painting with Color and Light*

April 1, 2017—August 13, 2017 | Gallery 123–125

\*Denotes ticketed exhibition. Pricing varies.