

general policies

Basic Safety Policies

- Please do not touch the artwork, frames, bases, walls, or protective coverings.
- Maintain a safe distance from all artwork. Two feet is recommended. An alarm may sound as a reminder. Please refrain from gesturing near the artwork.
- Food and drink are not allowed in museum galleries. Please enjoy refreshments in the Main Lobby, Schmidlapp Wing (Gallery 151), the Great Hall and the Alice Bimel Courtyard.
- Children must be accompanied by an adult at all times. Please visit our website for additional policies.
- For the safety of children and the art, wagons are not permitted in the galleries. Strollers, small baby slings and carriers are permitted, but we ask parents to be mindful of their surroundings.
- Touch and Learn exhibits are clearly marked and are meant for hands-on experience.
- Please refrain from running, yelling or disruptive behavior.
- Courtesy to others should be exercised when using cell phones.
- Smoking, including electronic smoking, is not permitted inside the museum, including courtyard and library balcony.
- For safety and health reasons, visitors should wear appropriate attire, including shoes and shirts.

Coat Room

All packages, briefcases, shopping bags and items larger than 11 x 15 x 4 inches must be stored in the coat room located in the Main Lobby or DeWitt Entrance Lobby. Lockers are available at no charge. Please store umbrellas in the coat room. The museum is not responsible for items lost or stolen. All items are subject to inspection and the museum reserves the right to decide what should be checked.

Wheelchairs and Strollers

The DeWitt entrance is accessible. The museum also provides wheelchairs and strollers free of charge. They are located in the coat rooms by each entrance.

Sketching

Sketching with pencil and colored pencil is permitted in all permanent galleries during our regular hours, and does not require completion of copyist permit form. Visitors who wish to copy a work of art using additional materials must complete a copyist permit. Copyist permits are available online or at the visitor service desk. The completed copyist permit should be given to the Visitor Services Desk. Sketching and copying is not permitted in special exhibitions nor of works undercopyright.

membership. you belong here.

As a Cincinnati Art Museum member, you can be part of a community that shares your passion for creating a more vibrant Cincinnati.

Plus, enjoy exclusive membership perks:

- Free special exhibition tickets
- Discounts in the Terrace Café and Gift Shop
- Invitations to early exhibition openings and exclusive member events
- opportunities to become Friends of a curatorial department of your choice

Join or renew today.

Ask at the Visitor Services desk or email membership@cincyart.org or call (513) 639-2966.

cincinnati  art museum

Visit cincinnatiartmuseum.org or call (513)-721-ARTS (2787)



visitor guide

cincinnati  art museum

Open Tuesday through Sunday, 11 a.m.–5 p.m.
Thursday, 11 a.m.–8 p.m.

welcome to the cincinnati art museum

Founded in 1881, our museum now holds a diverse, encyclopedic permanent collection of more than 67,000 works spanning 6,000 years. To make the most of your visit, stop by our Visitor Services Desk to pinpoint the galleries you want to visit, learn about special exhibitions or receive additional information. Our collection can also be viewed at cincinnatiartmuseum.com

overview

Admission Fees

General admission to the Cincinnati Art Museum is free every day, made possible by a gift from The Rosenthal Family Foundation.

Special Exhibition Ticket Fees

Pricing varies. Museum members receive FREE tickets to special exhibits.

Membership

Members enjoy FREE Special Exhibition tickets, preferred parking, discounts at the Terrace Café, the Museum Shop, and Library book sales, discounted and priority program registration, invitations to exhibition preview parties and more. To become a member, stop by the Visitors Services Desk for more information, call 513-639-2966, or visit cincinnatiartmuseum.org

Tours

The Cincinnati Art Museum offers free daily public tours.

- Tuesday–Sunday at 1 p.m. and Thursday at 6:30 p.m.
- Family ARTventures Tours Saturday at 2 p.m.
- Family ARTventures Art Stops Sunday at 2 p.m.

Guided and self-guided adult or school tours of the Cincinnati Art Museum can be scheduled by calling the Tour Coordinator at (513) 639-2975.

Device Charging

Outlets are located in the Schmidlapp Wing (Gallery 151) to charge electronics.

Photography

The Cincinnati Art Museum may photograph or videotape visitors for educational and marketing purposes. Attendance on museum property is implied consent for the use of visitors' likenesses in print, online, and display materials. If you prefer not to be photographed, please notify our photographer.

Personal Photography is allowed in the permanent collection galleries unless otherwise posted. Professional photography for portraits requires advance arrangements (at least two weeks) be made with our Special Events staff by emailing special.events@cincyart.org.

1st Floor



2nd Floor

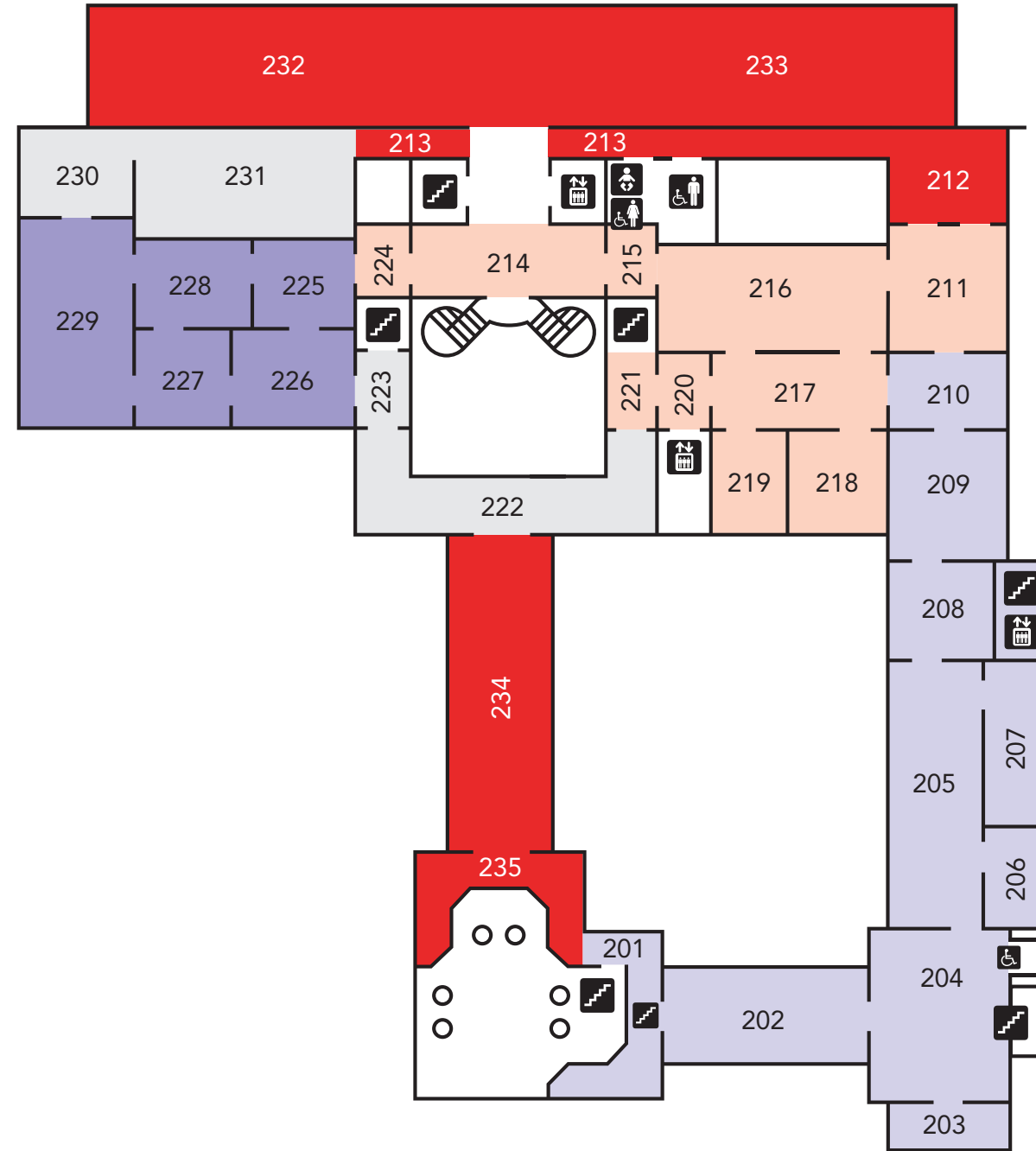

Ground Floor

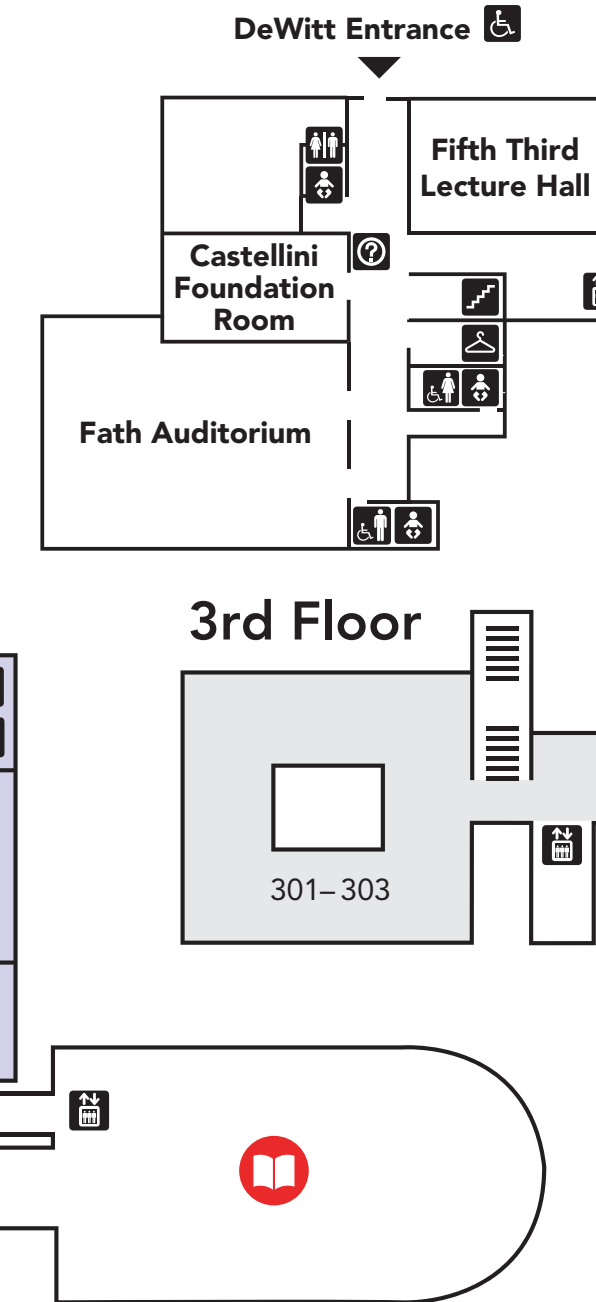

3rd Floor



what to visit

- Terrace Café**
 Enjoy a delicious selection of art-inspired fare, friendly servers and a tranquil atmosphere in our Terrace Café. Outdoor seating may be available in the scenic Alice Bimel Courtyard in warm weather. Museum members receive a discount. The Terrace Café is open Tuesday–Sunday, 11 a.m.–3 p.m. A limited menu is served on Thursday evenings from 3–7:30 p.m. Café reservations can be made by calling 513-639-2986.
- Museum Shop**
 Find unique gifts and keepsake souvenirs based on the museum's permanent collection and our special exhibitions. The shop is open during regular museum hours. Complimentary gift wrap available. Members receive a discount.
- The Mary R. Schiff Library**
 With a collection of over 100,000 items spanning 6,000 years of art history, the library is open to the public and has highly-qualified librarians to assist visitors. Located on the third floor in the Longworth Wing, the library is open Tuesday–Friday from 11 a.m.–5 p.m. as well as the second Saturday September through June.
- The Rosenthal Education Center**
 The Rosenthal Education Center (REC) is an interactive space for families to explore art together. Located on the first floor just off the Great Hall, the REC is open Tuesday–Sunday 11 a.m.–5 p.m. Thursday hours are 11 a.m.–8 p.m.
- Coffee Bar**
 Have a seat and enjoy treats and a cup of gourmet coffee or tea. Open during regular museum hours; service ending 30 minutes prior to the museum's closing.
- MyCAM**
 MyCAM Art Hunts are digital tours that you customize. Choose from eight thematic art hunts to personalize your museum visit. Once you pick your theme, you will be prompted to choose five specific works of art. Stop by the digital tables in Schmidlapp Wing (Gallery 151) to design your tour today.

■ SPECIAL EXHIBITION / FEATURE SPACE
 ■ AFRICAN ART
 ■ AMERICAN ART
 ■ EAST ASIAN ART
 ■ CINCINNATI WING
 ■ EUROPEAN ART 14TH–18TH CENTURY
 ■ EUROPEAN ART 19TH–20TH CENTURY
 ■ MODERN & CONTEMPORARY ART
 ■ NEAR EAST & ANCIENT ART
 ■ SOUTH ASIAN & ISLAMIC ART

Generously supported by:

